

Type PC42 Load Cell

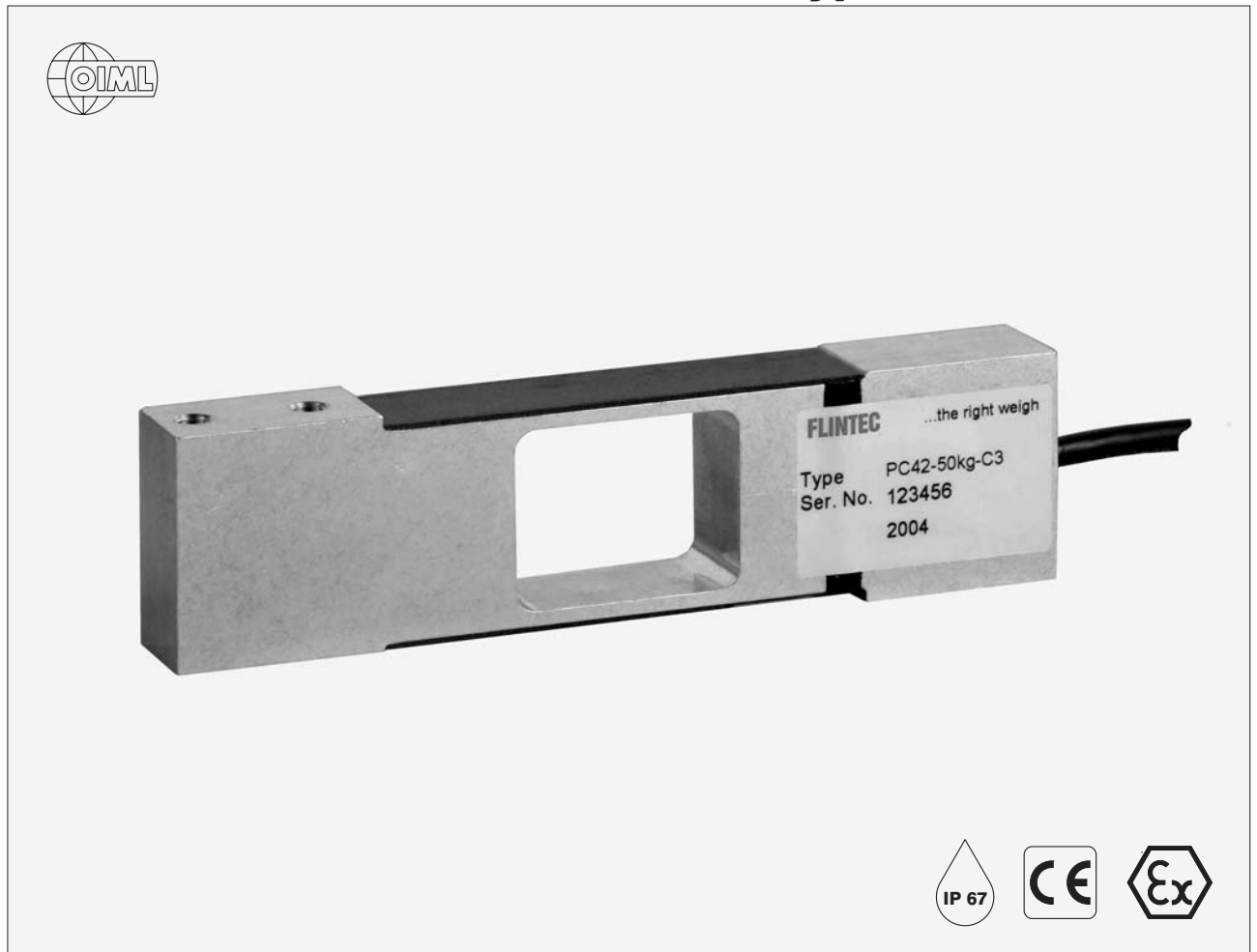

Flintec load cells are designed to meet the most stringent accuracy requirements. Certifications have been obtained from Weights & Measures Authorities, worldwide.

The PC42 platform load cells are available in the capacities 5 kg to 100 kg and include Accuracy Classifications GP and C3 according to OIML R 60.

They offer aluminium construction and improved potting, making them suitable for use in industrial environments.

The off center load performance according OIML allows a maximum platform size of 400 x 400 mm.

The PC42 is available for use in hazardous areas zone 0, 1, 2 (gas) and 20, 21, 22 (dust) according to EEx ia IIC T6...T4 T150°C ATEX.

Important Features

- Capacity: 5 kg to 100 kg.
- High accuracy.
- Aluminium construction.
- Protection IP 67.
- Maximum platform size 400 x 400 mm.
- W&M certified for 3000 intervals.

Option

- Explosion protection zone 0, 1, 2 and 20, 21, 22 ATEX.
- C3 with Y=15000.

PC42 Specifications

Maximum capacity	(E _{max})	kg	5 / 10 / 20 / 30 / 50 / 100	
/Rated Output	(Cn)	mV/V	2 ± 10%	
Accuracy class according to OIML R 60			(GP)	C3
Maximum number of verification intervals	(n _{max})		n.a.	3000
Minimum load cell verification interval	(v _{min})		n.a.	E _{max} /6000
Temperature effect on minimum dead load output		%Cn/°C	≤ ± 0.0040	≤ ± 0.0023
Option	Min. load cell verification interval (v _{min})		n.a.	E _{max} /15000
	Temp. effect on min. dead load output	%Cn/°C	n.a.	≤ ± 0.0009
Combined error		%Cn	≤ ± 0.040	≤ ± 0.020
Creep error (30 minutes) / DR		%Cn	≤ ± 0.060	≤ ± 0.016
Temperature effect on sensitivity		%/°C	≤ ± 0.0020	≤ ± 0.0011
Excitation voltage		V	5...15	
Zero balance		%Cn	≤ ± 5	
Input resistance		Ω	413 ± 20	
Output resistance		Ω	350 ± 25	
Insulation resistance (100 V DC)		MΩ	≥ 5000	
Compensated temperature range		°C	-10...+40	
Operating temperature range		°C	-20...+65	
Safe load limit	(E _{lim})	%E _{max}	150	
Ultimate load		%E _{max}	300	
Safe side load		%E _{max}	100	
Maximum platform size; loading according OIML		mm	400 x 400	
Maximum off center distance at maximum capacity		mm	135	
Load cell material			aluminium	
Sealing			potted	
Protection according DIN 40.050			IP 67	

Dimensions

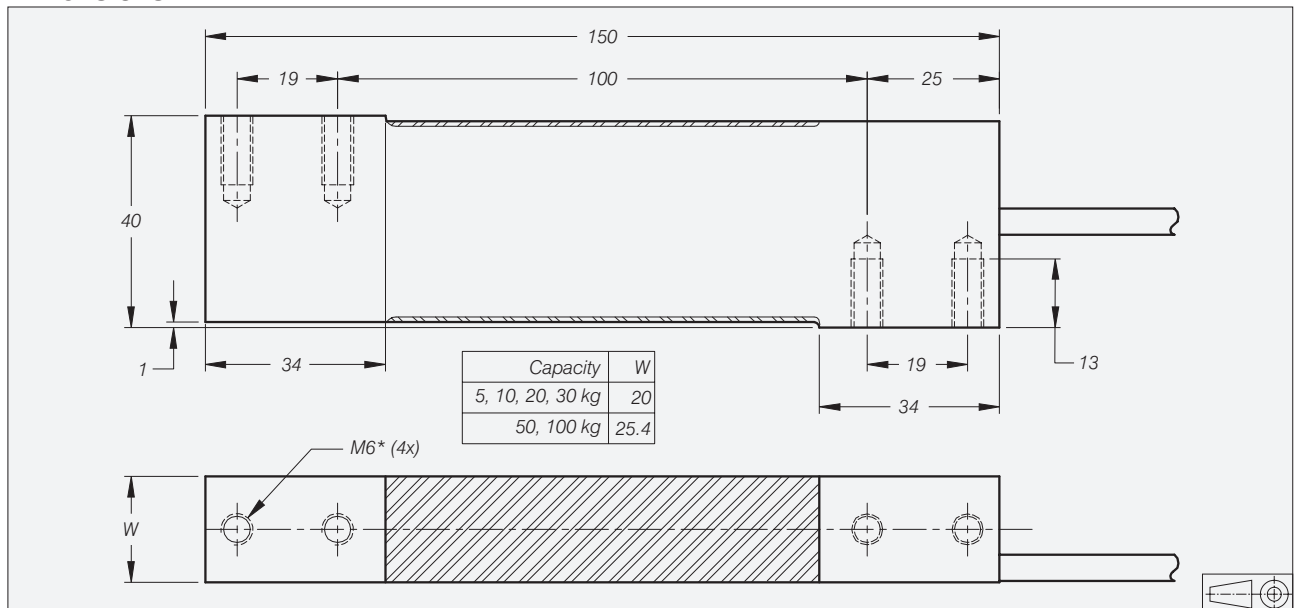

All dimensions in mm. Dimensions and specifications are subject to change without notice.

Mounting bolts M6 8.8; torque 10 Nm. Torque value assumes oiled threads.

* Unified thread 1/4-20 UNC is available.

Wiring

- The load cell is provided with a shielded, 6 conductor cable (AWG 26). Cable jacket polyurethane.
- Cable length: 1 m.
- Cable diameter: 5.8 mm.
- The shield is connected to the load cell body.

